

Canon R30

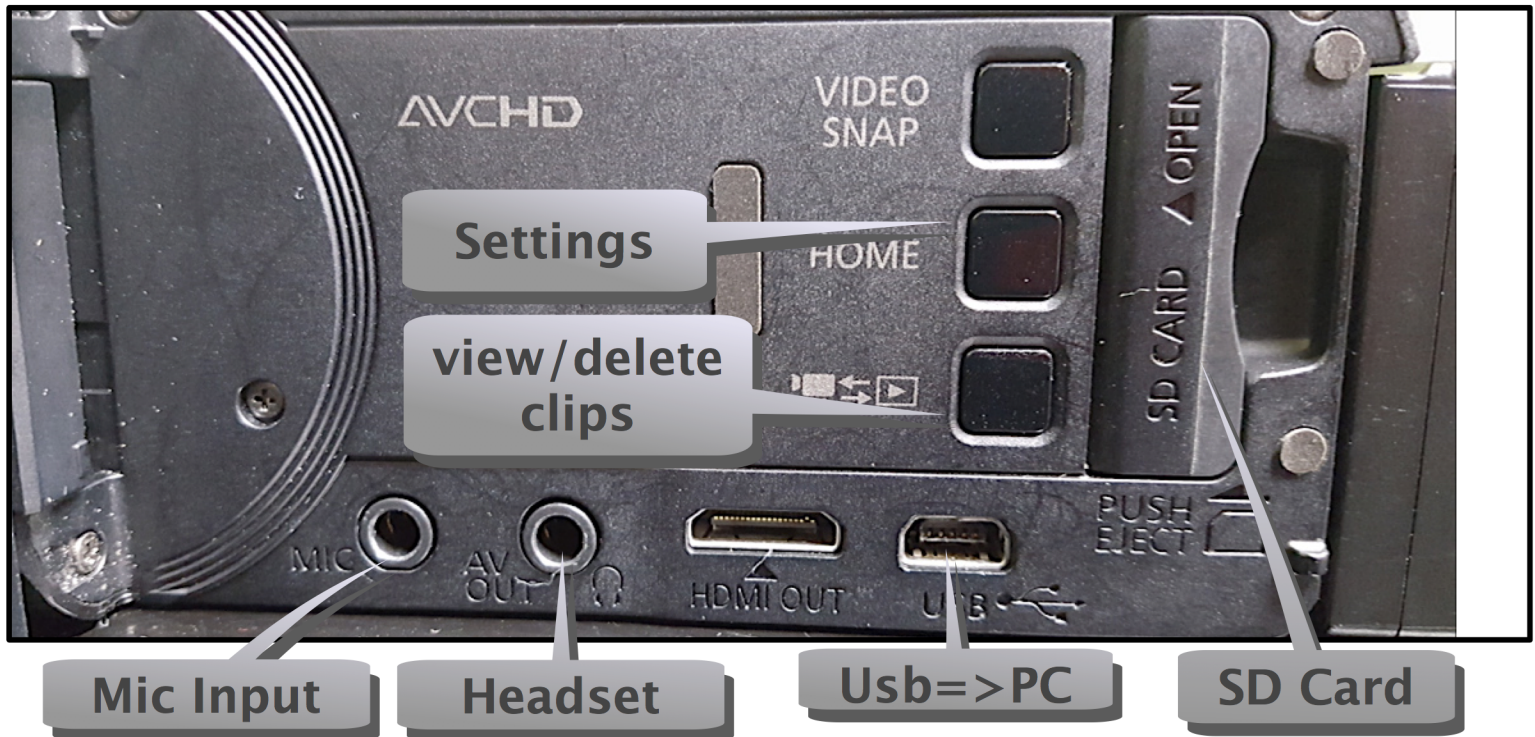

When you first turn on the camera, the screen displays basic settings.

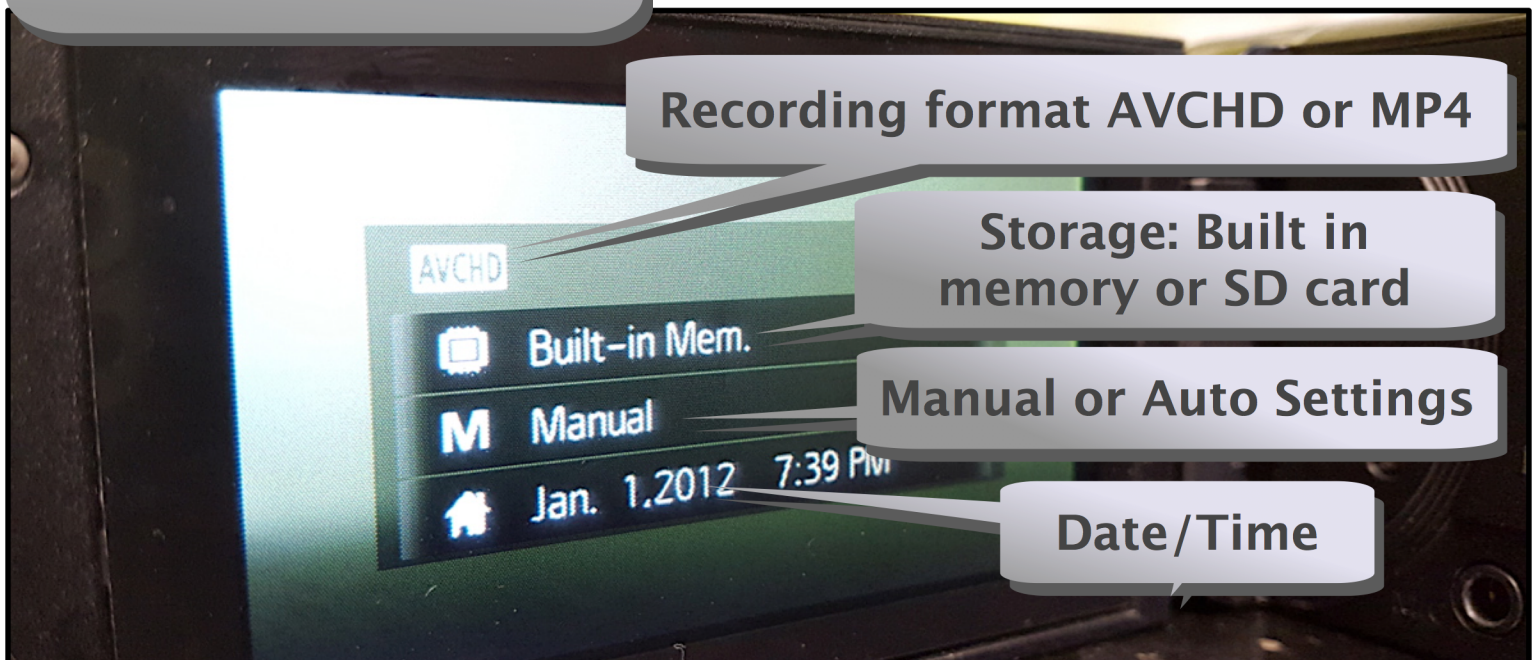

ON SCREEN DISPLAY



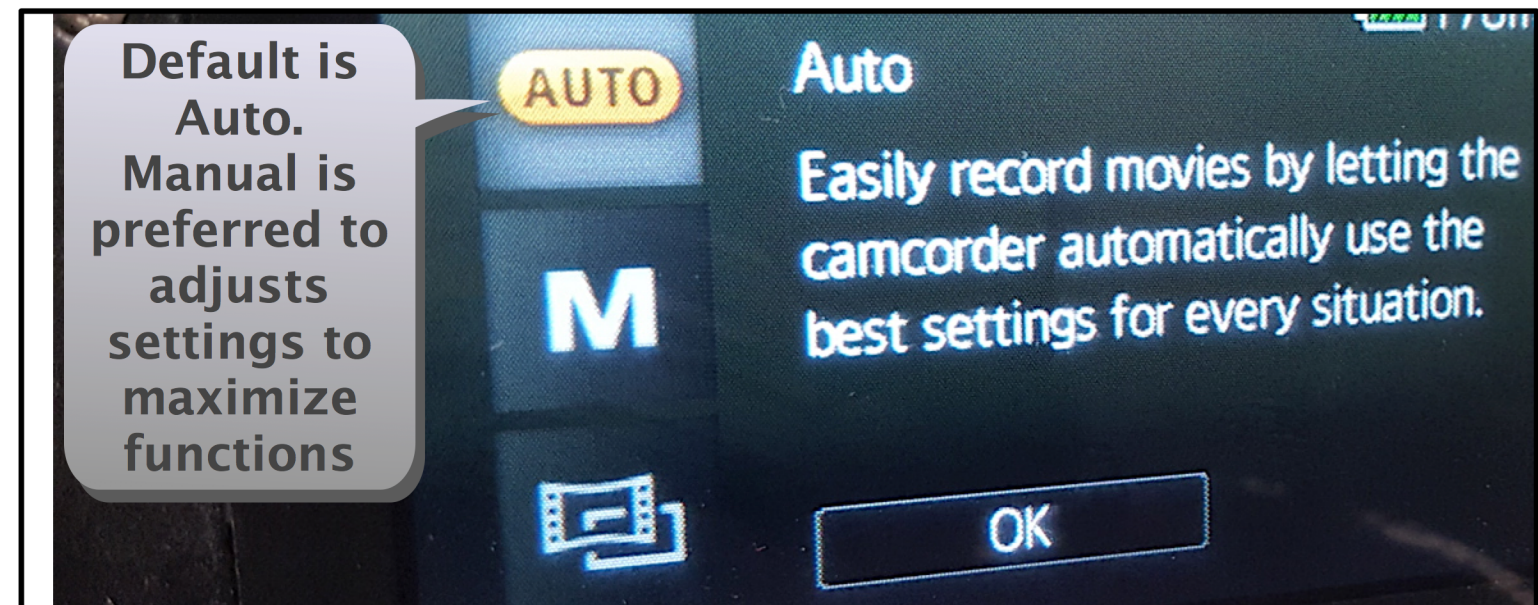

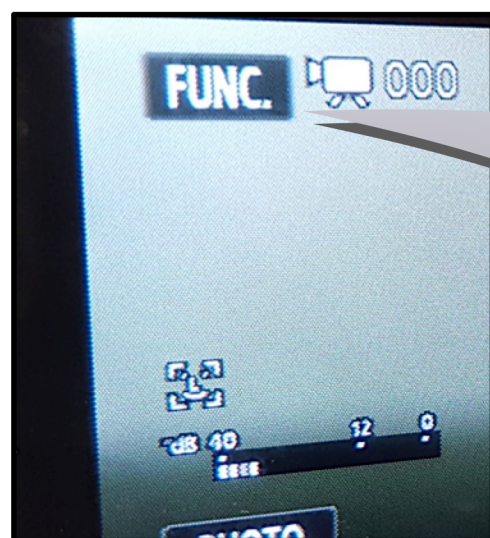
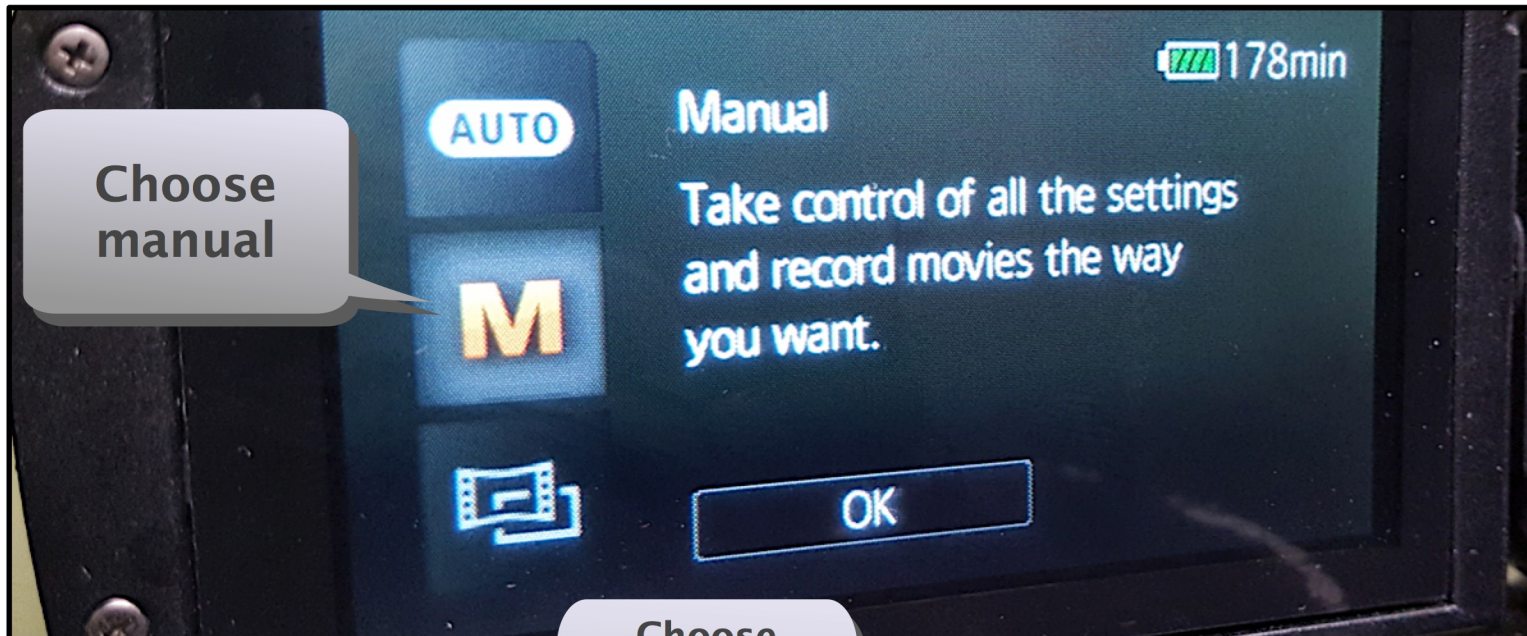

Choose "Functions" By selecting from main Screen or hitting Home button and choosing "Main functions"

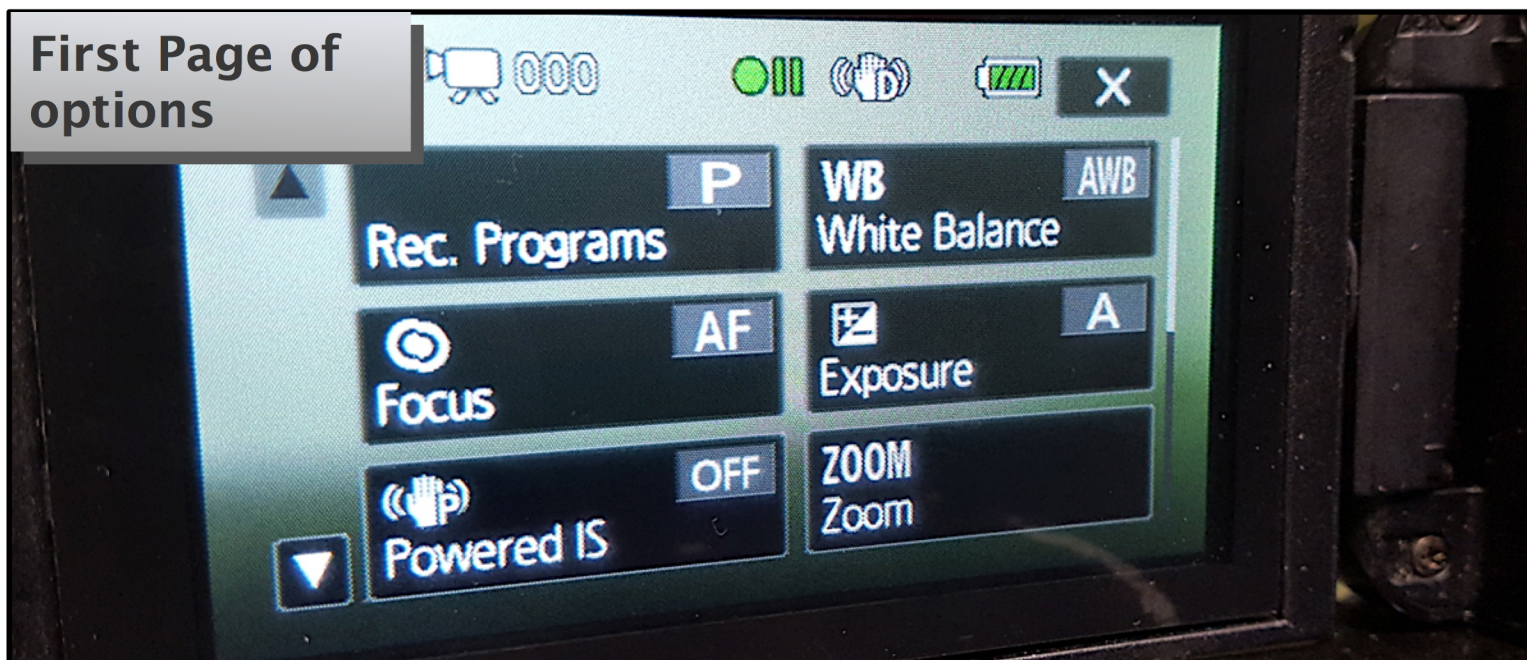

2nd Page of options



Choose Mic Level



Select Auto

Make sure Audio Level Indicator is on



Select Recording Standard

AVCHD-
Streaming
format. Needs
processed
through
iMovie.

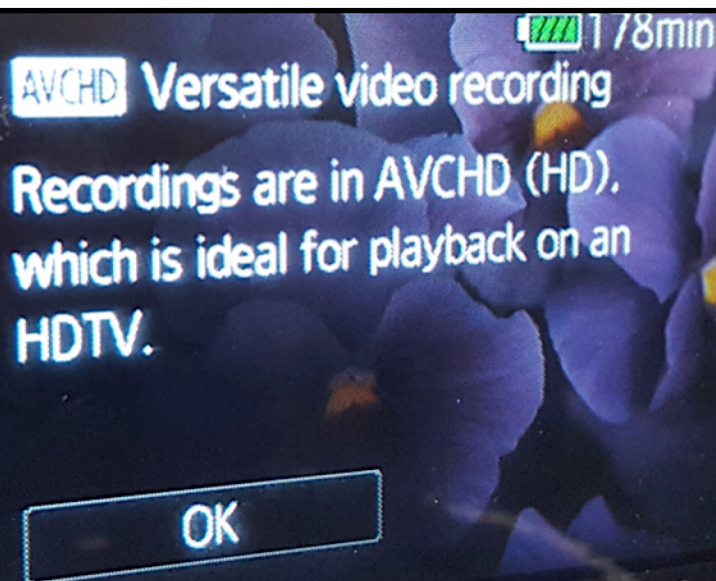

MP4- Can be
dragged off
directly. Only
records 30
minute files at
a time.

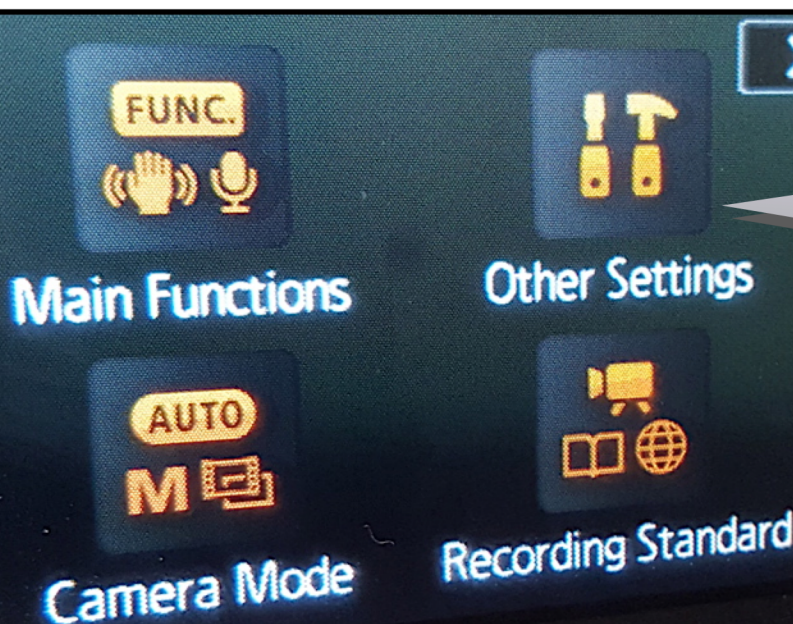

Choose
"Other
Settings"



1st Screen– Camera Tab



2nd Screen– Camera Tab



1st Screen– Film reel tab





