

EXPRESS SCRIBE FOR mac

0:00:00.0 Express Scribe

Sync Load Load & Delete Dock Scribe Mini Preferences Help

| Dictation Name | Sender | Date | Time | Duration | Priority | Deac |
|-----------------------------|---------|------------|----------|----------|----------|------|
| Have You Ever Seen the Rain | Unknown | 2011-10-24 | 17:52:47 | 2:14 | Normal | |

Speed (100%)

0:00:00.0

Express Scribe v 5.10 © NCH Software

connect transcriber pedal



connect your
transcribing
pedal to the
computer via the
usb port and
cable



place your
transcription
pedal on the floor

SETTING UP THE PEDAL



First click on Preferences and then click on the Controller tab. Finally, click 'Controller setup wizard'

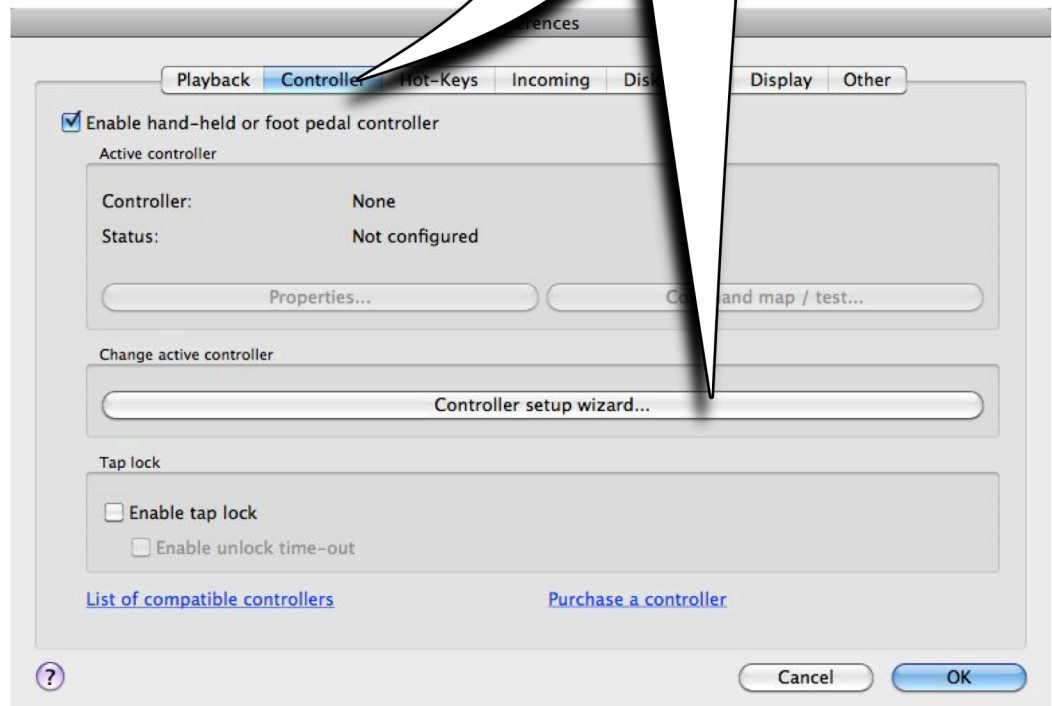

Setting up the pedal (cont)

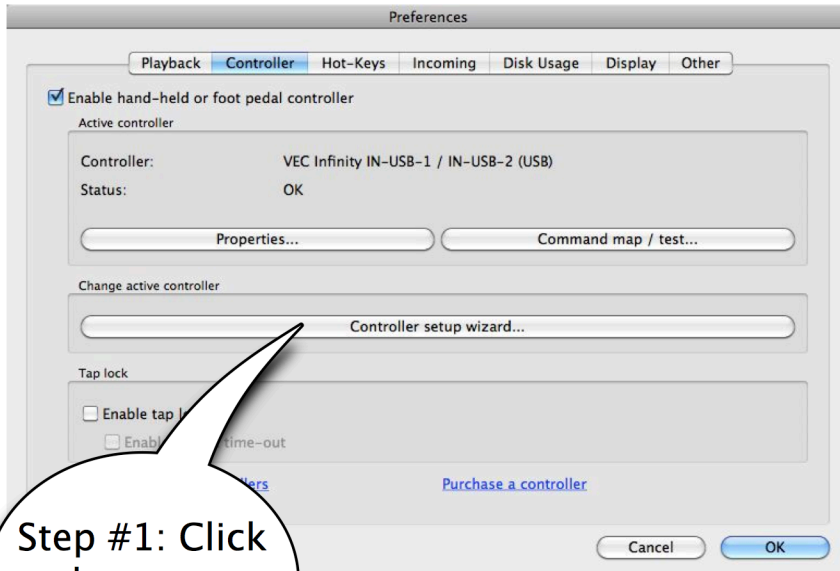

Step #1: Click the setup wizard

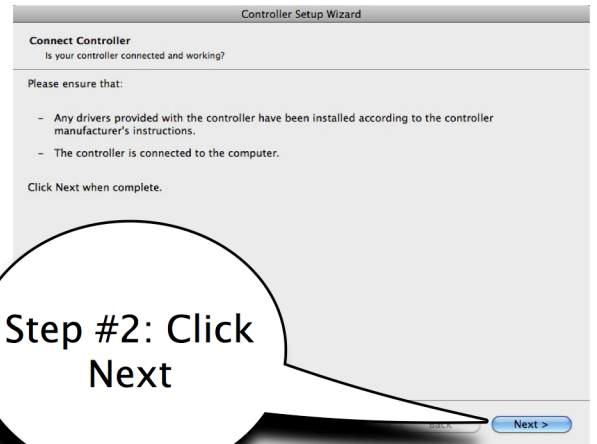

Step #2: Click Next

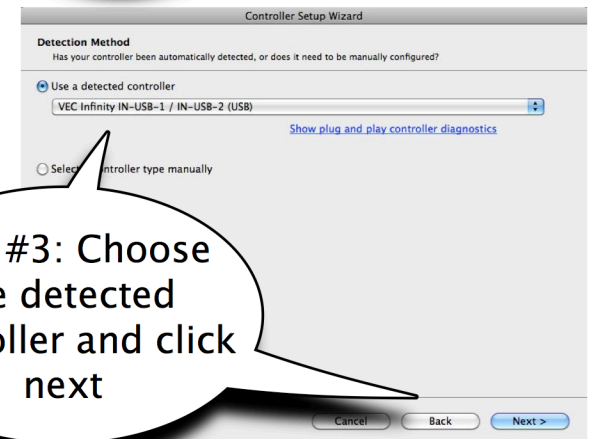

Step #3: Choose the detected controller and click next

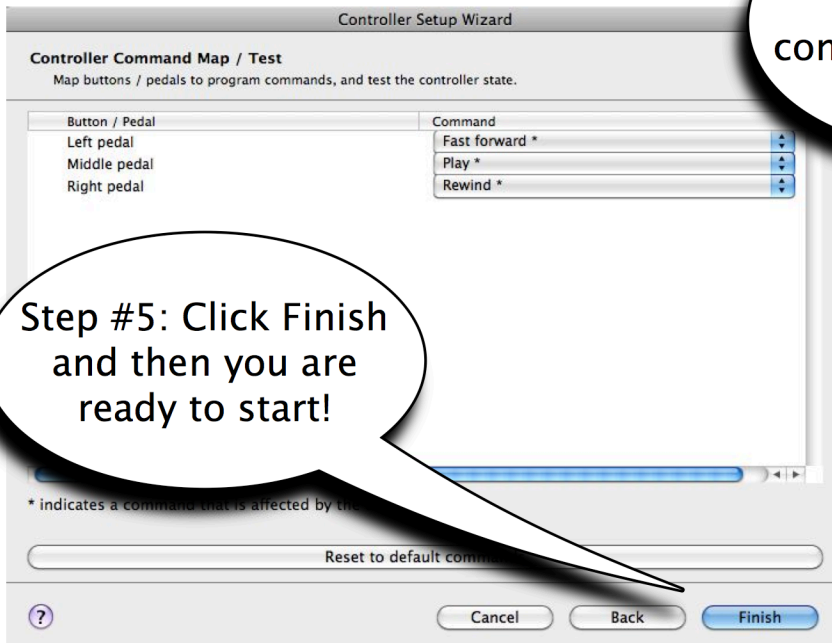

Step #5: Click Finish and then you are ready to start!

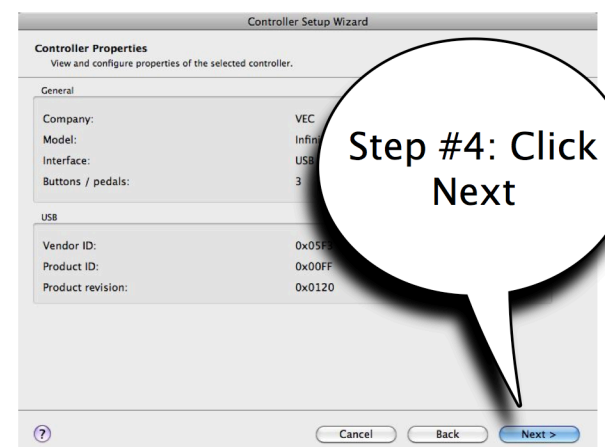

Step #4: Click Next

LOADING A FILE TO TRANSCRIBE



Click load to select a file to transcribe

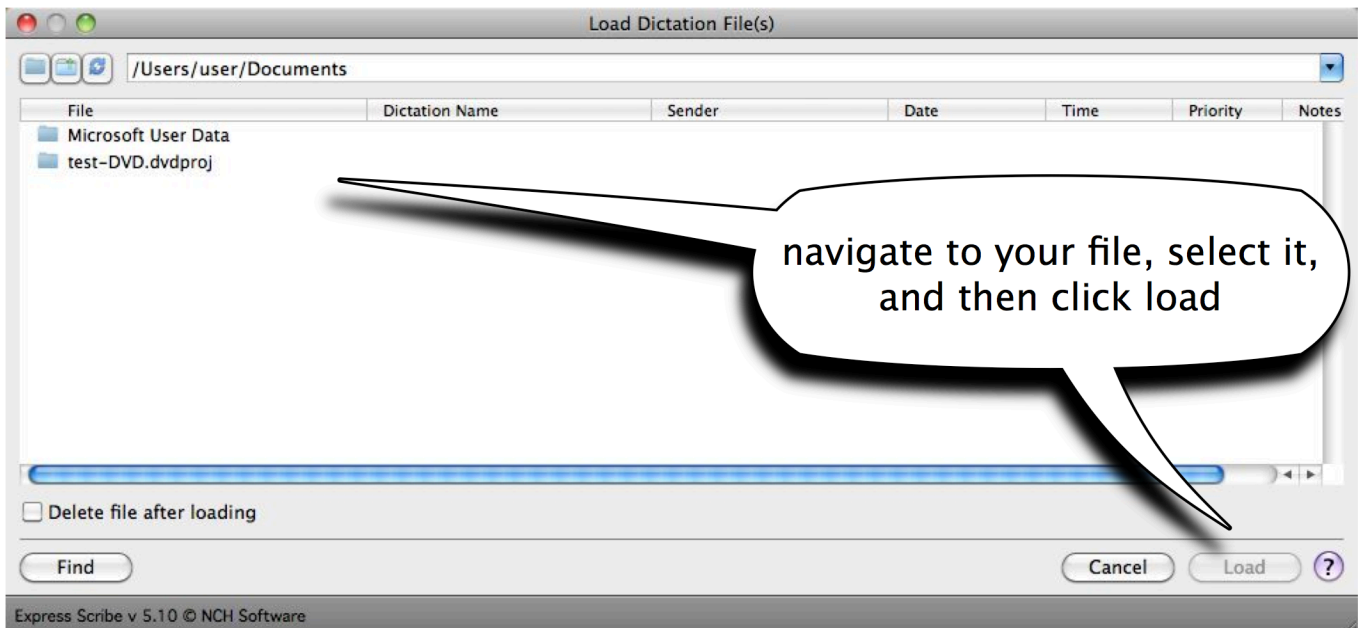

navigate to your file, select it, and then click load

using the transcription pedals and adjusting the speed

utilize the pedals to navigate your recording

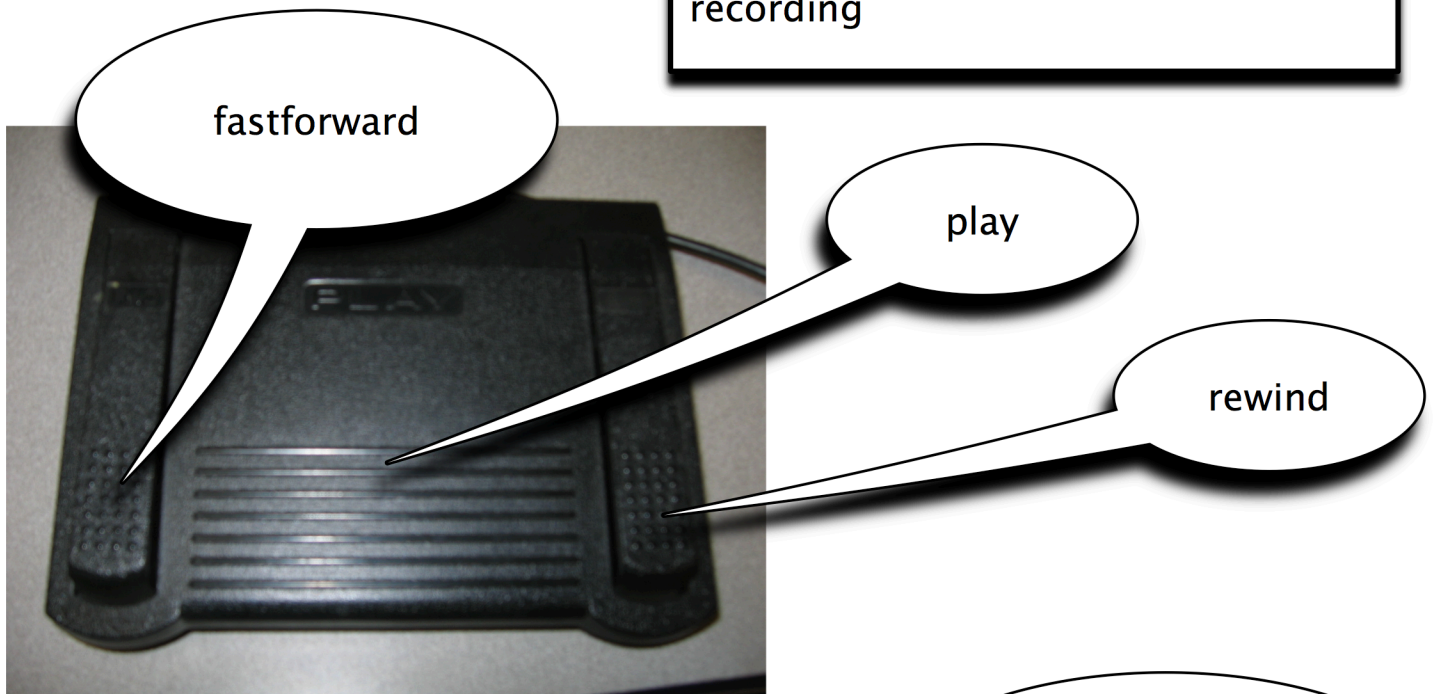

you can slow down or speed up your recording by using the sliding speed bar

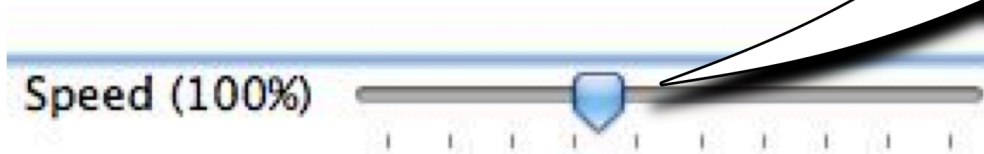

Typing Your Transcription

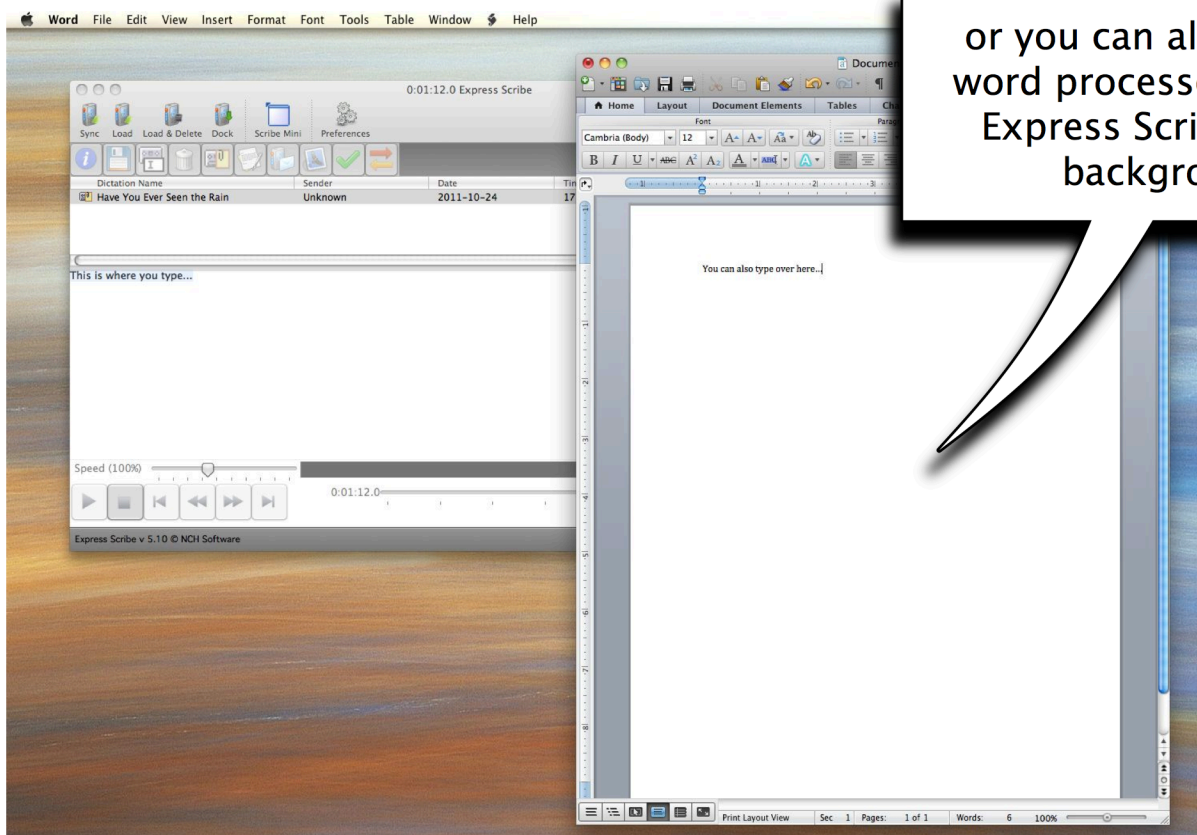
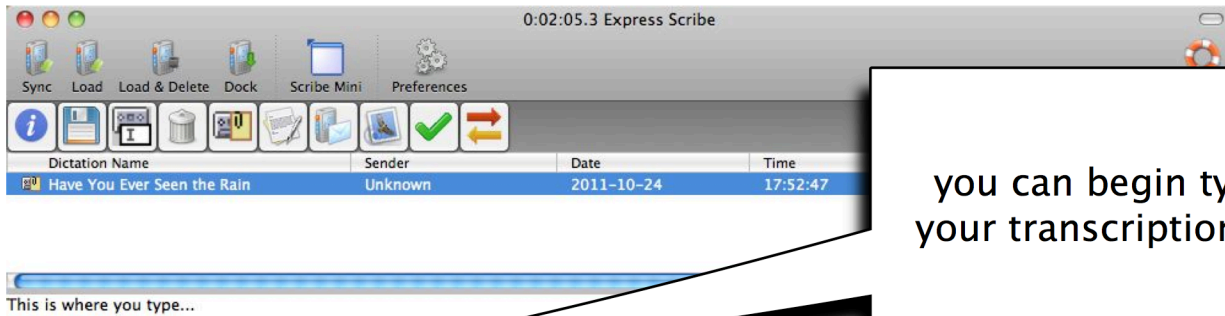

or you can also open a word processor and use Express Scribe in the background

saving

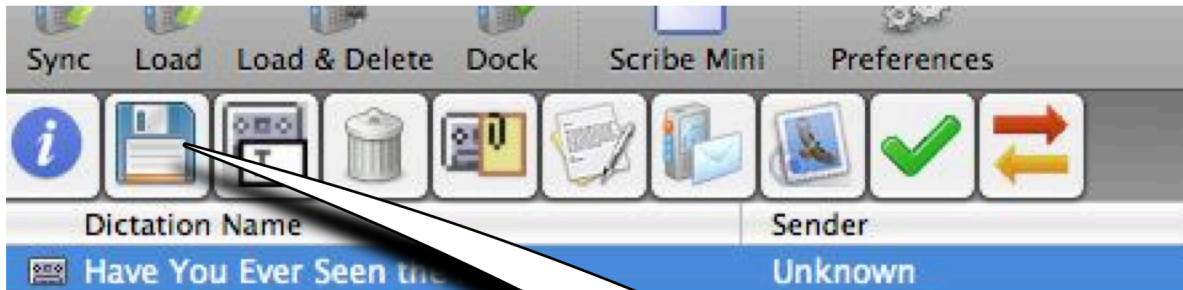

Be sure to save your work by clicking the floppy disk sign icon

